

Specifications

194

Axle



SPICER OFF-HIGHWAY PRODUCTS



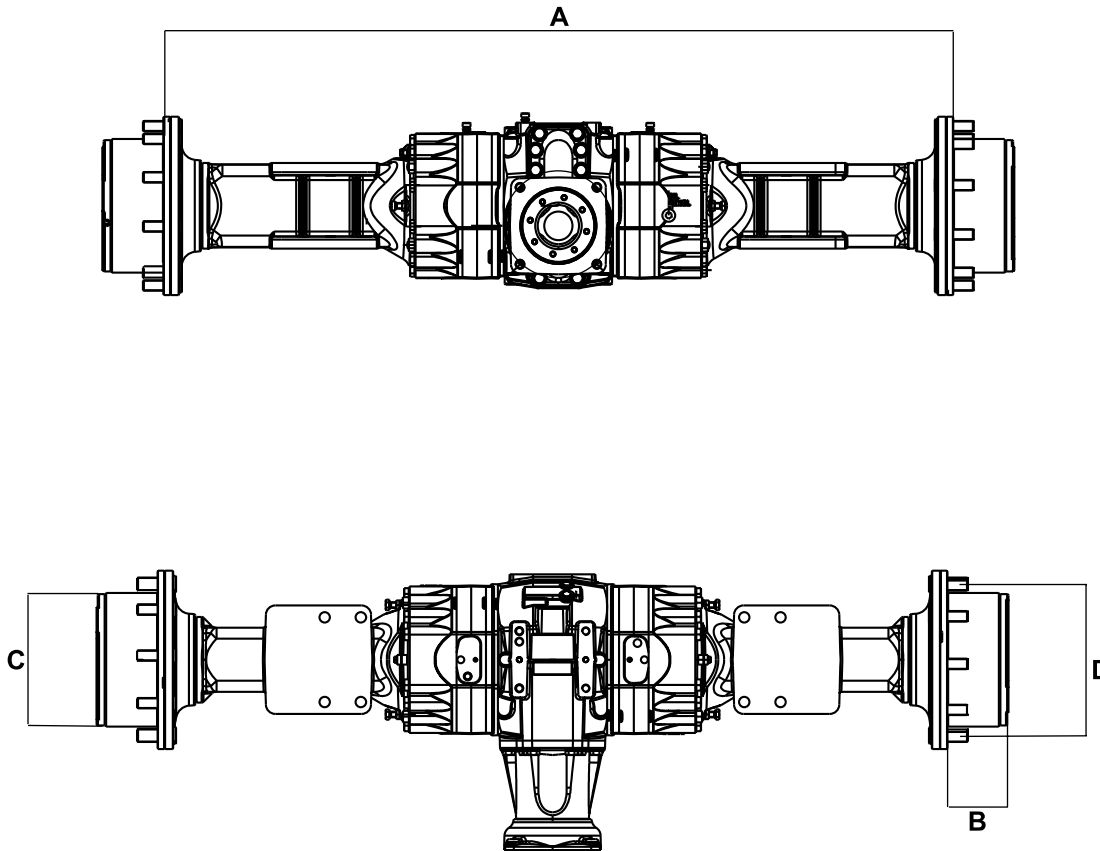

DESIGN FEATURES	
Axle mounting	Rigid mounting with pads
Bevel gear	Hypoid spiral bevel gear
INPUT:	Direct connection for hydraulic motor (different model and spline available)
Planetary final drive	1:6.00 (3 - 4 planets)
Service brakes	None
Parking brake	Spring Applied Hydraulic Released integrated
Differential lock options	Limited slip 45% NO-SPIN

INSTALLATION DIMENSIONS (mm)	
A Track width	1660
B Planetary hub length	107,7
C Wheel pilot	280
D Wheel bolt circle	335

TECHNICAL DATA	
Planetary reduction ratio	1:6.00
Tooth combination	6:43
Overall ratio	1:43.00
Max. output torque (daNm)	5300 (3 planets) - 6500 (4 planets)
Load capacity (daN): static	20000
Load capacity (daN): dynamic	10000



SPICER OFF-HIGHWAY AXLE DIVISION
 Zona Industriale - 38062 Arco (Trento), Italy
 Tel: +39 0464 580111 Fax: +39 0464 580444

APPLICATION POLICY
 Capability ratings, features and specifications vary depending upon the model type of service. Applications must be obtained from Spicer Off-Highway Axle Division.
 We reserve the right to change or modify our product specifications, configurations, or dimensions at any time without notice.