

eS10H Spicer Torque-Hub™

Benefits

- Spicer Torque-Hub™ eS10H product design with TM4 Electrodynamics™ Integrated advanced motor technologies
- Greater efficiency and compact package size for electric Mobile Elevated Working Platform

Features

- Electric Wheel Drive to meet Slab Scissor fully electric drive performance requirements
- Torque rating of 1.000 Nm
- Designed specifically for electric Slab Scissor duty cycle to perform reliably for the life of the machine
- Minimal TCO – minimum maintenance requirements and high efficiency reduces operation cost and energy consumption
- Reducing CO₂ emissions through electrification improves overall carbon footprint



Ideal for Mobile Elevated Work Platforms

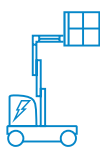
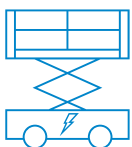

eS10H Spicer Torque-Hub™

Electric Wheel drive specifically designed for high efficiency AC slab scissor machine. Double stage planetary in combination with TM4 Electrodynamics™ advanced electric motor technologies offers a best-in-class efficiency package delivering power-dense and best-in-class torque and power performance.

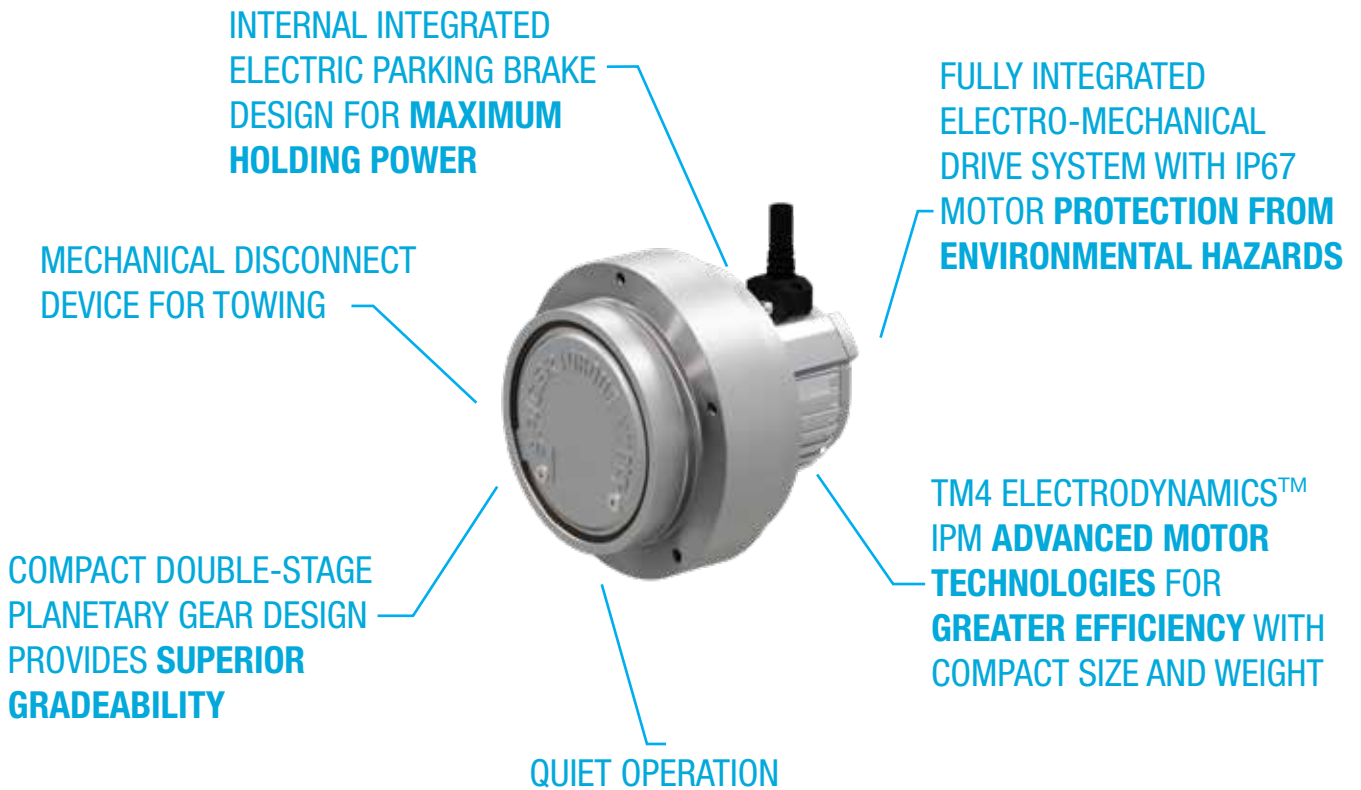

eS10H	
Output Torque Rating Nm [lbf ft]	1,000 [738]
Reduction Ratio Range	31-52
Electric Motor Type	IPM 120-40 IPM 120-60
Motor Max Speed rpm	5,000
Motor peak power kW [Hp]	3.5 [4.70] 4 [5.36]
Motor cont. power S2, 60min. kW [Hp]	1.5 [2.00] 2.1 [2.81]
Motor peak Torque Nm [lbf ft]	21 [15.48] 30 [22.13]

eS10H	
A - Flange to Flange mm [in]	84.5 [3.33]
B - Hub Length mm [in]	184 [7.25]
C - Wheel Pilot mm [in]	216 [8.50]
D - Wheel Bolt Circle Diameter mm [in]	171 [6.75]
E - Total unit length mm [in]	218* / 279** [8.60 / 11.0]

*IPM 120-40; **IPM120-60

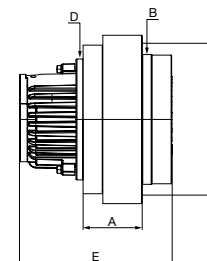

Dana.com/e-Mobility

Application Policy

Capacity ratings, features, and specifications vary depending upon the model and type of service. Application approvals must be obtained from Dana; contact your representative for application approval. We reserve the right to change or modify our product specifications, configurations, or dimensions at any time without notice.

